



MobiShow

Quick Installation Guide

(Model Name: MS-200)



Version: 1.5

Date: March 16, 2009

1) Package Contents

- MobiShow Box
- Power Adapter (DC +5V, 2.5A)
- CD-ROM with Smartphone & PC utilities and User's Manual inside.
- Quick Installation Guide
- Warranty Card
- Carry Bag

2) Physical Details

- Front Panel

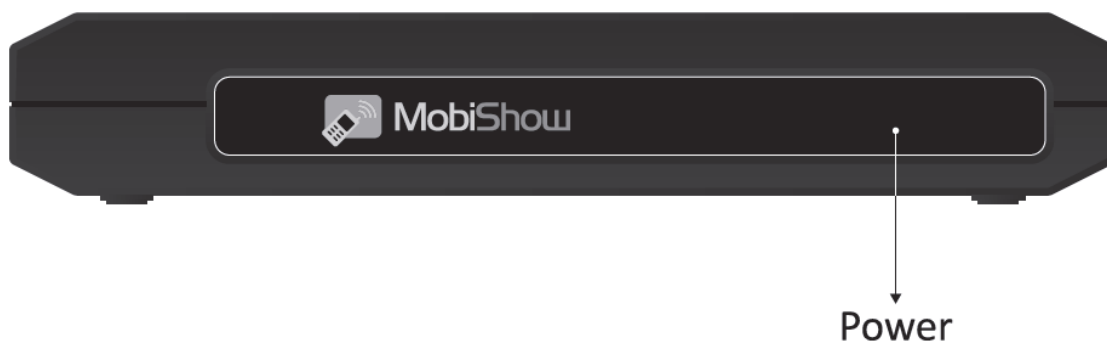

- Rear Panel

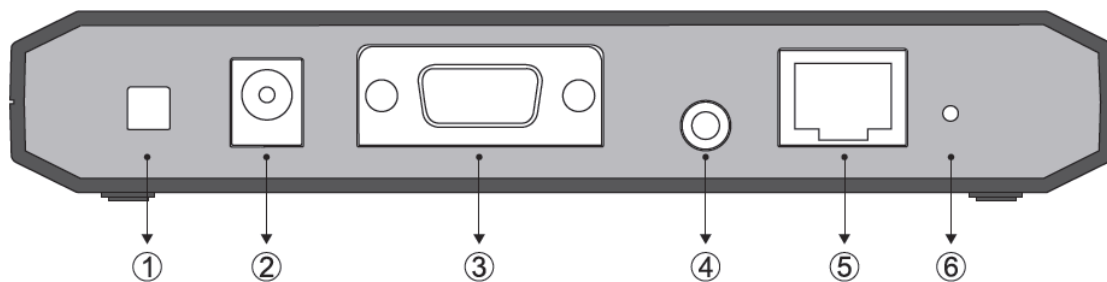

① Power Switch

② Power Jack

③ VGA Connector

④ Audio

⑤ RJ-45

⑥ Reset

3) Hardware Installation

- 1) Connect power adapter DC plug to MobiShow DC jack.

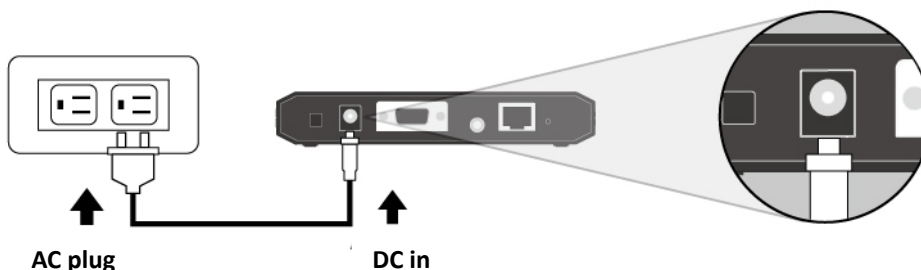

- 2) Connect Projector's VGA cable to MobiShow VGA connector on the rear panel.

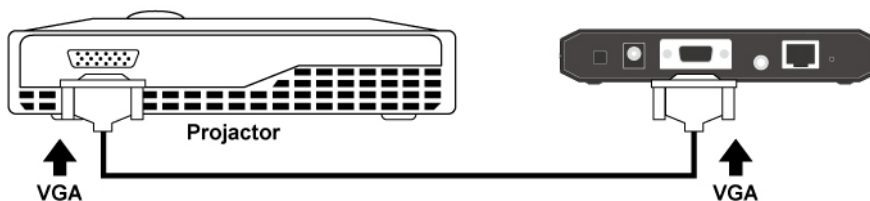

- 3) Turn on projector.
- 4) Turn on MobiShow box
 - ◆ After system ready, the "POWER" LED and "WLAN" LED will be yellow color. The "LAN" LED will be off.
 - ◆ When LAN connection is established, then "LAN" LED will be yellow color and blinking while data transmission.
- 5) When MobiShow is ready, the following screen is shown.



4) Software Installation

4.1 Download from MobiShow box

- 1) Turn on WiFi on your phone.
- 2) Connect your phone to MobiShow wireless network. The SSID is displayed on screen (default SSID is **MobiShow**).
- 3) Open the browser on your phone and enter the IP address of the MobiShow box.
 - ◆ The default IP address is **192.168.100.10**.
 - ◆ Or, refer to the IP address which shown on the projector screen.
- 4) The following web page will be shown on your browser.

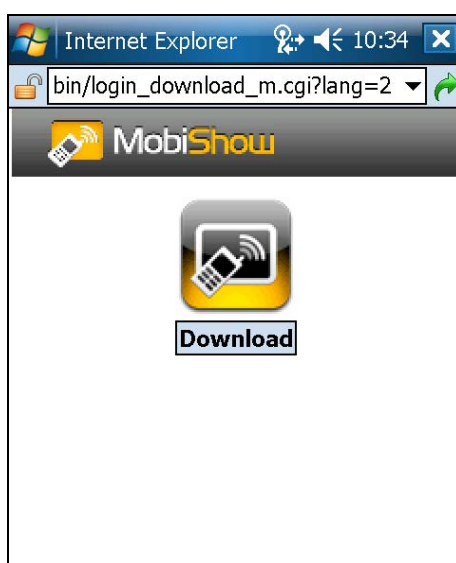

- 5) Click the “**Download**” link to download the software installer (in CAB format) to your phone.
- 6) Open Explorer on your phone and find the CAB file.
- 7) Double click on the CAB file to start installation.
- 8) Follow on-screen instructions to finish installation.

4.2 Install from CD

- 1) Connect your Windows Mobile phone to PC. Make sure it is connected in ActiveSync.
- 2) Insert MobiShow Setup CD to PC.
- 3) The AutoRun program will automatically bring up the Setup page. If the system asks you what to do on CD insertion, please select “**Launch MobiShow Setup CD**”.
- 4) On the Setup page, select “**Install to Phone**”.
- 5) Follow the on-screen instructions to install software to PC.
- 6) When prompted, check the screen of your phone to finish installation on your phone.

5) Using MobiShow with a Smartphone

- 1) Open “**Programs**” on your phone and find “**MobiShow**” application.
- 2) Select “**MobiShow**” icon  to launch the client software.
- 3) MobiShow will turn on Wi-Fi on your phone and list available access points for you to choose.



- 4) Select a MobiShow wireless network (SSID with prefix MobiShow) to connect to.
- 5) MobiShow client will connect to that access point and search for MobiShow devices automatically. When a MobiShow device is found, it will automatically login and the following main menu is shown on your phone.

